

# Fact Sheet

**BIZERBA**

## iL Professional 20F/HY

*The stand-alone load receptor impresses as single, dual or multi-interval scale with a high weighing range resolution and a low design.*



**More information**  
High performance  
with a wide range of  
solutions and options.

Specifications	Facts	Details
<b>Weighing range</b>	3-15 kg	Interval: 1-5 g
<b>Load cell</b>	Strain gauge load cell BB15	– The selection of high quality materials makes this load receptor also suitable for use in extreme environmental conditions – Load cell in stainless steel version
<b>Dimensions</b>	335x260 mm	W x D
<b>Materials</b>	Stainless steel	Load frame and load platter
<b>Overall height</b>	75-90 mm	Level adjustment by means of foot screws, approx. + 15 mm
<b>Mounting method</b>	freestanding	Table or floor mount
<b>IP rating</b>	IP67	Load cell and cable junction box (compound filled)
<b>Explosion-proof version</b>	Zone 1/21	Load cells in Ex ib version for Ex zone 1/21
	Zone 2/22	Additional plate for Ex zone 2/22
<b>Ambient temperature</b>	-10 °C to +40 °C	Operation
	-50 °C to +85 °C	Storage

Options	Facts	Details
<b>Preload compensation</b>	see table	
<b>Roller conveyor not powered</b>	Mounted to platform	Compensated as fixed preload
	Frame: Aluminum u-shaped profile	Drip-proof Not suitable for hazardous area Not suitable for wet areas Load platter size: 335x260 mm Load capacity: 30 kg Weighing ranges: 3, 6, 12, 15 kg Number of rollers: 8 Roller pitch: 44 mm Roller conveyor height: 77 mm Frame dimensions: 338x252 mm Axle diameter: 6 mm Roller exterior diameter: 30 mm Roller wall thickness: 1.8 mm Max. roller conveyor load: 20 kg if load is evenly distributed over the entire roller conveyor Max. individual roller load: 10 kg
	Rollers: Plastic (blue)	
	Bearing: Ball bearing	
	Axes, cross-struts: Stainless steel	

Minimum length of material to be conveyed: 90 mm

Net weight: approx. 2.5 kg

## Info graphics

### Symbols

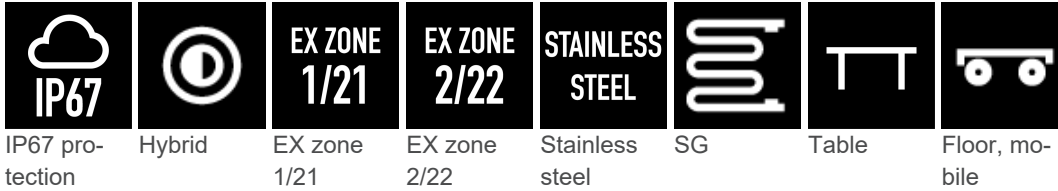

### Dimensional drawings

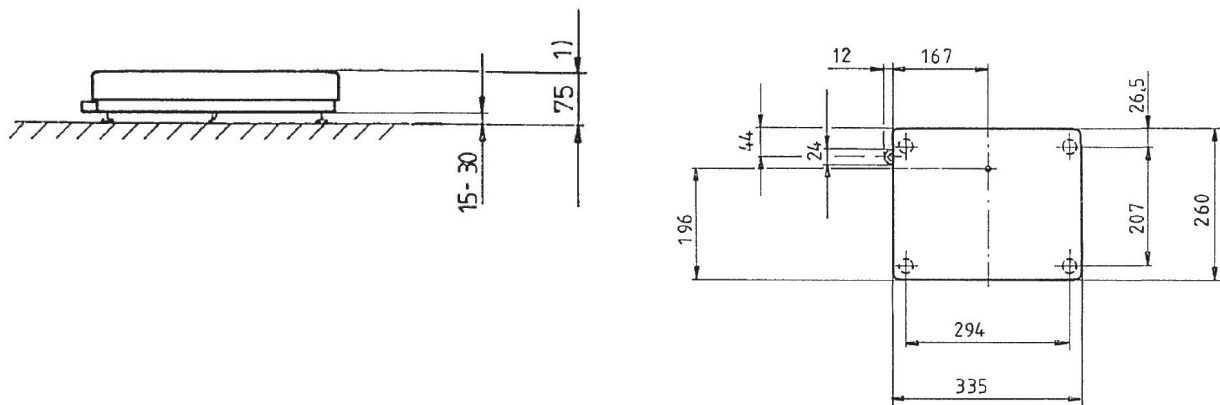

### See also

 [Anhang\\_iL\\_Professional\\_20F\\_HY.pdf](#) [▶ 3]

Weighing range	Scale interval	Dimensions	Load cell	max. preload	Roller conveyor	Version		
						All stainless steel	Electro galv./ stainless steel	Ex
6 kg	2 g	335 x 260 mm	SG load cell BB 15	10 kg	X	X		X
12 kg	2 g			4 kg	X	X		X
15 kg	5 g			1 kg	not possible	X		X
6/15 kg	2/5 g			1 kg	not possible	X		X
3/6/15 kg	5/10 g			1 kg	not possible	X		X

---

**Bizerba SE & Co. KG**

Wilhelm-Kraut-Straße 65  
72336 Balingen

T +49 7433 12-0  
fax: +49 7433 12-2696  
marketing@bizerba.com

**[www.bizerba.com](http://www.bizerba.com)**